

# Flue gas and transportation fan MT Arr.4

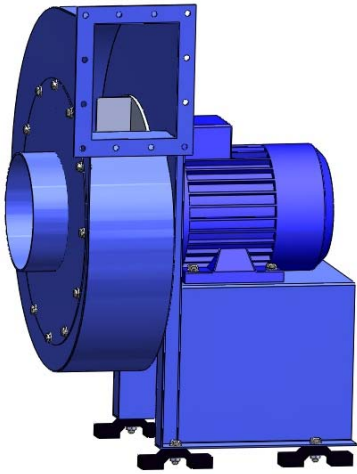

The MT fans are specially designed to meet the requirements of an industrial fan. The capacity range for a directly driven version is from 50 m<sup>3</sup>/h to 7000 m<sup>3</sup>/h, and the fans are suitable for flue gas, exhaust, dusty air, and transportation of sawdust. In the standard version the fans are primed and painted, but we can also deliver versions treated with epoxy, galvanized, in stainless steel or acid proof metal. Extra equipment is flexible connections, vibration dampers, drain plug, spark protection, etc.

Dimension sketch

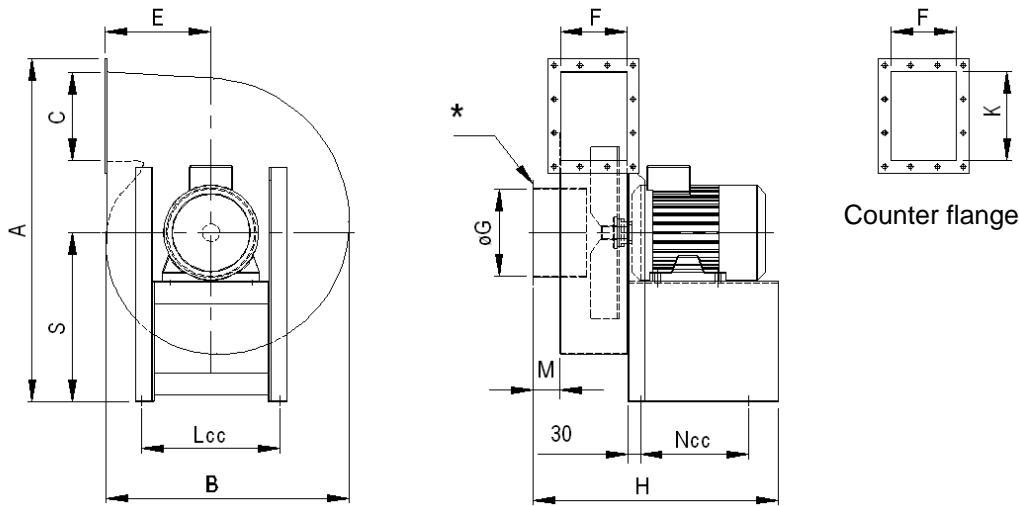

Table of dimensions

\*Flange on the inlet is standard as of str. 250

Type	A	B	C	E	F	øG	H	K	Lcc	Mcc	N	S	Vekt, kg
75	-	290	78	127	65	75	-	80	-	40	-	-	8
100	457	336	105	148	75	100	349	107	205	50	130	241	20
125	529	395	127	173	95	125	399	129	230	50	160	275	25
150	597	448	152	195	115	150	446	154	230	57	170	305	40
175	684	508	178	220	133	175	504	180	270	57	210	350	50
200	763	564	203	246	152	200	566	205	320	60	250	392	65
250	933	679	254	296	190	250	610	257	350	64	250	482	80

Measurements can be changed without prior notice. Note! Stated weight is excluding motor.

Positions.

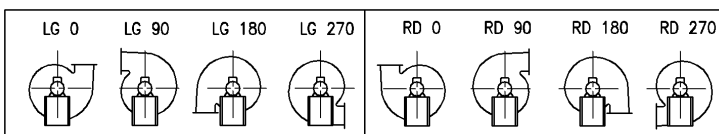

Viewed from the drive side.